



C-Band Transmit Reject Filter

12086 Series

These filters offer extremely low loss, typically less than 0.04 dB on receive signals while providing a high degree of transmit rejection ranging from 50 to 80 dB, depending upon the model. Alternate flange configurations are available upon request.

Series 12086

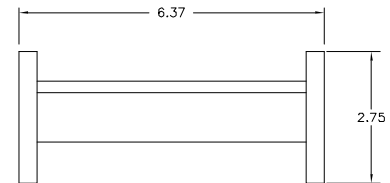
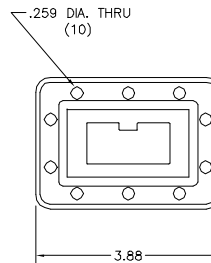

Specifications:

Model	12086-1	12086XR-1	12086-2	12086XR-2	12086-3	12086XR-3
Waveguide Size:	WR-229	WR-229	WR-229	WR-229	WR-229	WR-229
Frequency (GHz):	3.7 - 4.2	3.7 - 4.2	3.625 - 4.2	3.625 - 4.2	3.4 - 4.2	3.4 - 4.2
Insertion Loss:	0.06 dB Typ	0.06 dB Typ	0.06 dB Typ	0.06 dB Typ	0.10 dB Max	0.10 dB Typ
VSWR:	1.15:1 Max	1.25:1 Max	1.15:1 Max	1.25:1 Max	1.25:1 Typ	1.25:1 Max
Reject (GHz):	5.925 - 6.425	5.925 - 6.425	5.850 - 6.425	5.850 - 6.425	5.825 - 6.725	5.825 - 6.725
Attenuation:	50 dB Min	80 dB Typ	70 dB Min	80 dB Typ	70 dB Typ	80 dB Typ
Flanges:	CPRG 229					
Weight:	0.95 lbs (0.43Kg)					
Dimensions:	6.37" x 3.88" x 2.75" (162mm x 98mm x 70mm)					
Finish:	Gloss White Lacquer					

MICROWAVE FILTER CO., INC.
6743 KINNE STREET, E. SYRACUSE, NY 13057
E-Mail: mfcsales@microwavefilter.com

800-448-1666 • 315-438-4700
Web: www.microwavefilter.com