



# Ku-Band Receive Reject Filter

## Model 19593 SERIES

These filters provide deep rejection of the receive band with minimal effect on the transmit band.

- *Ideal for Higher Power Transmit Applications.*
- *Alternate Flange Configurations are Available Upon Request.*

### Specifications:

Passband:	13.75 – 14.50 GHz
Passband Loss:	0.25 dB Typ
VSWR:	1.20:1 Max
Power (CW):	1.0 kW Max
Rejection:	20 dB Min @ 13.56 GHz 80 dB Min from 10.70 – 12.75 GHz 35 dB Min @ 15.00 GHz
Flanges:	See Chart (below)
Weight:	3.5 Lbs. Approx
Dimensions:	5.00" x 2.60" x 2.00" (127mm x 66mm x 51mm)
Finish:	White Lacquer

### Flange Configurations

Model	Input Flange	Output Flange
19593-1	WR75 Flat Cover	WR75 Flat Cover
19593-2	WR75 Grooved Cover	WR75 Flat Cover
19593-3	WR75 Flat Cover	WR75 Grooved Cover
19593-4	WR75 Grooved Cover	WR75 Grooved Cover

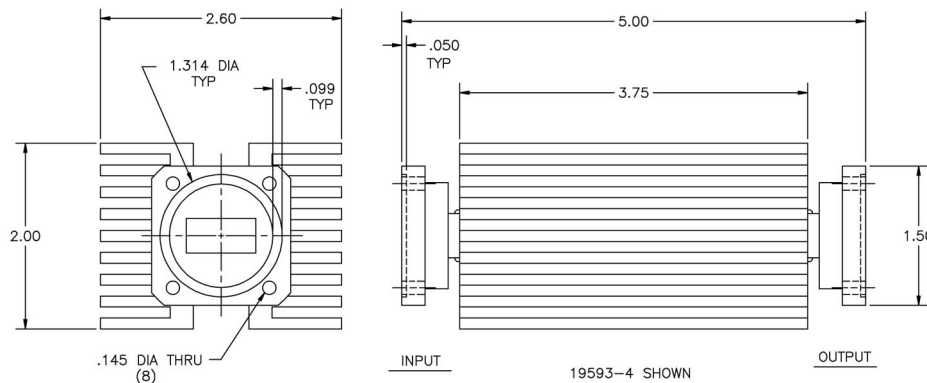

**MICROWAVE FILTER CO., INC.**  
 6743 KINNE STREET, E. SYRACUSE, NY 13057  
 E-Mail: [mfcsales@microwavefilter.com](mailto:mfcsales@microwavefilter.com)

800-448-1666 • 315-438-4700  
 Web: [www.microwavefilter.com](http://www.microwavefilter.com)