



# Isolator/Circulator

## IS-5961-100N-NM/NF

### Specifications:

Frequency Range:	595-615 MHz
Insertion Loss:	0.3 dB Max
Isolation:	23 dB Min
VSWR:	1.2:1 Max
Average Power:	100 Watts Max
Reflection Power:	100 Watts Max
Impedance:	50 Ohms
Connectors:	N male, N female
Operating Temp. Range:	-20°C to +70°C

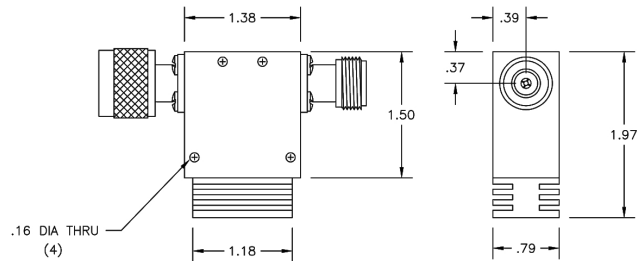

**MICROWAVE FILTER CO., INC.**  
6743 KINNE STREET, E. SYRACUSE, NY 13057  
E-Mail: [mfcsales@microwavefilter.com](mailto:mfcsales@microwavefilter.com)

800-448-1666 • 315-438-4700  
Web: [www.microwavefilter.com](http://www.microwavefilter.com)